

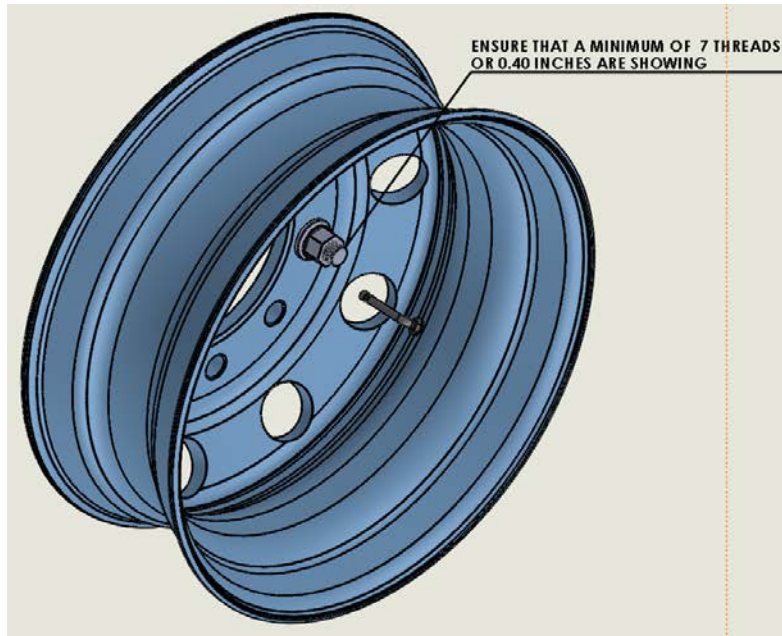

Instructions for installation of LWS on Wheels

1. Check that 7 stud threads are showing beyond the top of the lug nut. This will ensure full thread engagement once the LWS SENSOR RING is installed.



2. Remove every second lug nut (5 in total).
3. It is recommended that studs and nuts are inspected with a 5 in 1 Wheel End Component Inspection Gauge



4. Inspect each removed nut for corrosion and damage. Check that the two-part swivel base is in good order. Replace all faulty lug nuts. Clean lug nuts removing corrosion and debris.
- 5.

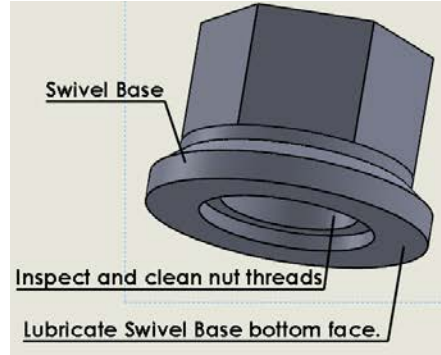

6. Lubricate bottom face of lug nut with grease.
*** This is an important step to avoid torque from damaging the sensor ***
7. Clean the 5 exposed studs and with a wire brush and clean rim face.
8. Apply one drop of lubricant to each stud
9. Place Isolation Gasket onto the rim

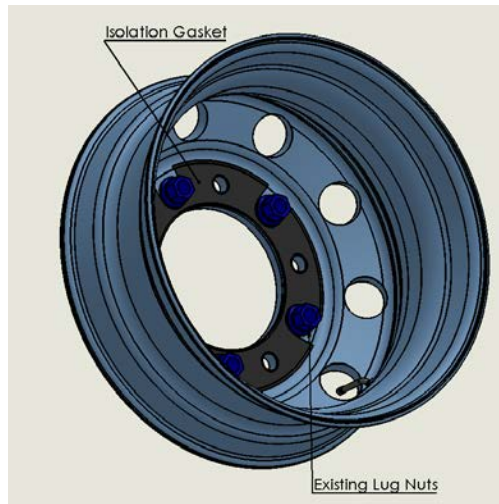

10. Install LWS Sensor Ring onto Rim and torque nuts to 500 ft-lbs.

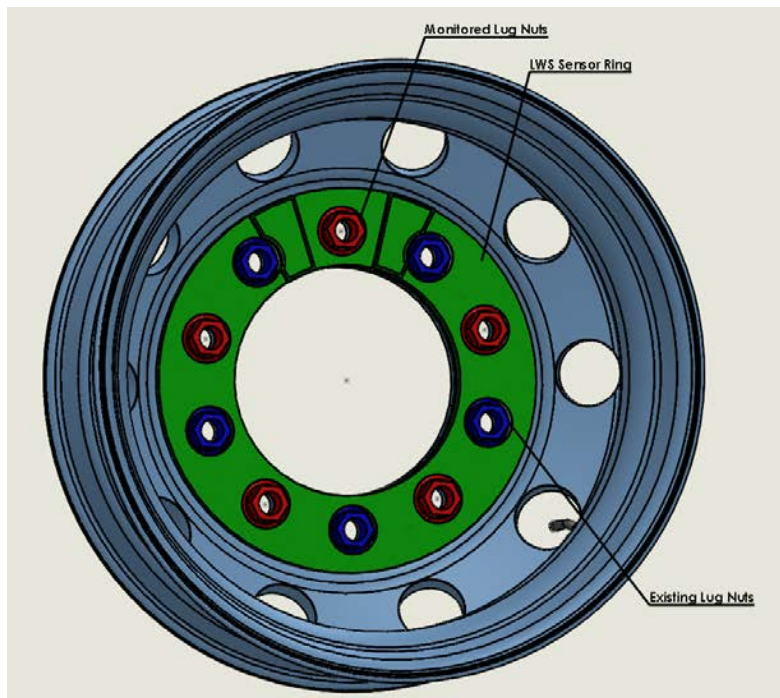
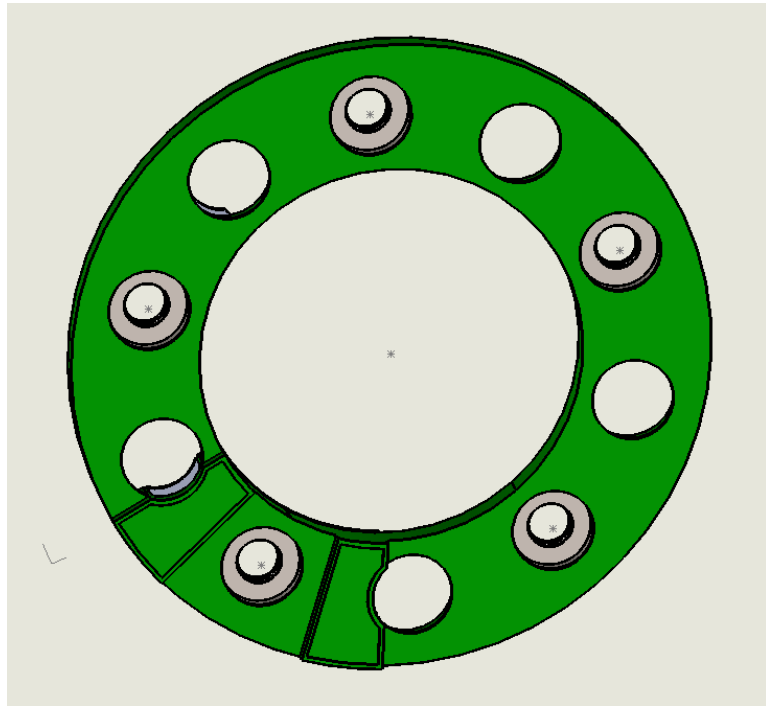



Instructions for installation of Alarm Beacon

1. Attach black power wire from the Alarm Beacon to the blue wire on the 7-way attached to the trailer.



2. Check beacon for power- Solid green light



3. Lift the black flap on the back of Beacon, and reset the light by pressing and holding reset button for 5 seconds.

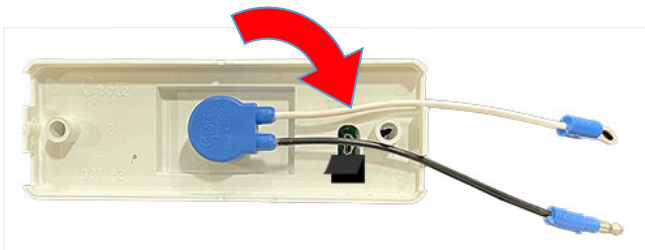

4. Wait for flashing red light- Alarm Beacon is now reset.
5. Attach Alarm Beacon to the front left side of trailer, making sure ground wire is connected.
6. Place magnet over Loose Wheel Sensor Ring marked plate for 2 seconds until red light comes on.



7. Repeat for remaining wheels while checking Alarm Beacon for transmission indicating signal.
8. When Alarm Beacon shows solid green light, system is now operational and all monitored lug nuts are connected with a threshold torque.

